

CITYLINE



22 Places City Bus

These are city class buses good for transporting passengers both sitting and standing. Exploitation conditions of these buses are very difficult, so the equipment installed in them is of peculiar reliability. They are always made with electric entrance doors and,

if there is a need, they can be made with platforms or ramps for loading disabled in wheelchairs. The seats of such buses are durable and decorated with materials easy to clean. Outside and inside digital indicator boards are installed to provide information.



Cityline



MODEL	SPRINTER 516CDI
Engine capacity	I-4 2143cc
Gross weight, kg	5000 / 5300
Power, kW/HP	120 / 163
Torque, Nm	360
Gearbox	Automatic
Tires	205 / 75 R16C

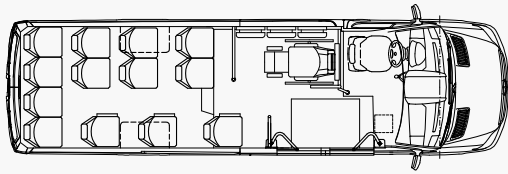

CITYLINE FOR 16 PASSENGERS

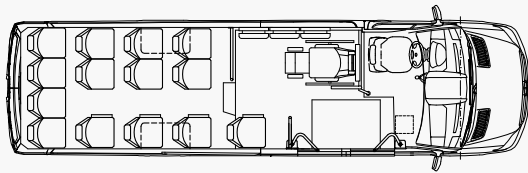

CITYLINE L FOR 17 PASSENGERS

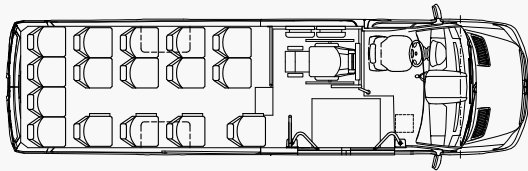

CITYLINE L FOR 18 PASSENGERS

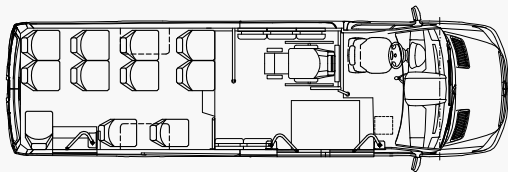

CITYLINE FOR 16 PASSENGERS
WITH 2 DOORS

MODEL	CITYLINE	CITYLINE L
Gross weight, kg	5000 / 5300	
Maximum seats (standing)	16 (6)	17 (5)
Wheelchair places	1	
DIMENSIONS		
Length, mm	7345	7645
Width, mm	1993	
Height, mm	2890	
Wheelbase, mm	4325	
Internal length, mm	4700	5000
Internal width, mm	1760	
Internal height, mm	1900	
SEATING		
Suburban type seats: * - fixed backrest / safety belts	S / O	
ENTRANCE DOORS AND EMERGENCY EXITS		
Power double door, electric	S	
Roof hatch (970x530mm)	S	
WINDOWS GLAZING		
Panorama side windows	S	
Single glazed rear door windows / plastic rear cover with stationary glass	S / O	
HEATING, CONDITIONING, VENTILATION		
Saloon air conditioner 5,5kw / 11,5kw	S / O	
Convectional heating	S	
Roof ventilator	S	
INTERIOR		
Flat floor with anti slip PVC	S	
Ceiling, saloon sides, window arches finish with upholstery or feaux leather	S	
Grabhandles behind the driver and at the entrance	S	
Watch - thermometer with STOP indication	S	
AUDIO - VIDEO		
CD Radio / Microphone with amplifier	S / O	
Loudspeakers in the ceiling	S	
LED destination board front / rear	S / O	
EXTERIOR		
Bumpers and moldings painted in body colour	O	
Metal wheel covers	S	

S - serial O - optional