

ART. 400M

CODICE ORDINE Bestell-Nr. Order No.	DIMENSIONI Abmessungen Dimensions (mm.)							RD.. 1003...	VT35	CVB 35	BT15	kg	STOCK
	D	d	H	p	β	z							
400M 042-10/6	42	16	44	5	-	6	RD.. 1003...					0,240	●
400M 052-12/5	52	22	50	6	5,7°	5	RD.. 12T3...					0,360	●
400M 066-12/6	66	27	50	6	4,1°	6	RD.. 12T3...					0,610	●
400M 080-12/7	80	27	50	6	3,2°	7	RD.. 12T3...					1,080	●
400M 052-16/4	52	22	50	8	8,8°	4	RD.. 1604...					0,330	●
400M 066-16/5	66	27	50	8	6,0°	5	RD.. 1604...					0,500	●
400M 080-16/6	80	27	50	8	4,5°	6	RD.. 1604...					1,050	●
400M 100-16/7	100	32	55	8	3,7°	7	RD.. 1604...	VT45	CVB 45		BT20	1,800	●
400M 125-16/8	125	40	55	8	2,8°	8	RD.. 1604...					2,300	●
400M 160-16/9	160	40	55	8	1,8°	9	RD.. 1604...					4,460	●

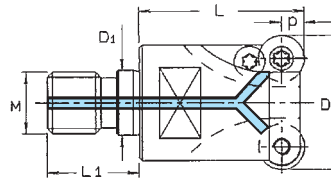

ART. 400MO

CODICE ORDINE Bestell-Nr. Order No.	DIMENSIONI Abmessungen Dimensions (mm.)								RD.. 0501...	VT18	BT06	kg	STOCK	
	D	L	M	D1	L1	p	β	z						
400MO D10/2	10	18	M6	6,5	14,5	2,5	28,9°	2	RD.. 0501...			0,010	●	
400MO D20/5	20	30	M10	10,5	20	2,5	6,9°	5	RD.. 0501...			0,060	●	
400MO D12/2	12	18	M6	6,5	14,5	3,5	22,7°	2	RD.. 07T1...			0,010	●	
400MO D15/2	15	23	M8	8,5	17,5	3,5	20,0°	2	RD.. 0702...			0,020	●	
400MO D15/3	15	23	M8	8,5	17,5	3,5	20,0°	3	RD.. 0702...			0,030	●	
400MO D20/4	20	30	M10	10,5	20	3,5	11,0°	4	RD.. 0702...	VT2530		0,060	●	
400MO D25/5	25	35	M12	12,5	22	3,5	7,3°	5	RD.. 0702...			0,100	●	
400MO D30/5	30	43	M16	17	24	3,5	5,4°	5	RD.. 0702...			0,200	●	
400MO D20/2	20	30	M10	10,5	20	5	39,0°	2	RD.. 1003...			0,050	●	
400MO D25/2	25	35	M12	12,5	22	5	14,3°	2	RD.. 1003...			0,100	●	
400MO D25/3	25	35	M12	12,5	22	5	14,3°	3	RD.. 1003...			0,090	●	
400MO D30/4	30	43	M16	17	24	5	9,3°	4	RD.. 1003...	VT35		0,200	●	
400MO D35/4	35	43	M16	17	24	5	7,3°	4	RD.. 1003...			0,200	●	
400MO D35/5	35	43	M16	17	24	5	7,3°	5	RD.. 1003...			0,250	●	
400MO D42/5	42	43	M16	17	24	5	5,4°	5	RD.. 1003...			0,250	●	
400MO D24/2	24	35	M12	12,5	22	6	-	2	RD.. 12T3...			0,100	●	
400MO D35/3	35	43	M16	17	24	6	-	3	RD.. 12T3...	VT35		0,200	●	
400MO D42/4	42	43	M16	17	24	6	8,3°	4	RD.. 12T3...		CVB 35	BT15	0,250	●
400MO D32/2	32	43	M16	17	24	8	-	2	RD.. 1604...	VT45	CVB 45	BT20	0,200	●

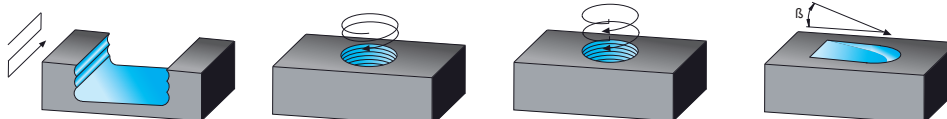

● Disponibile - Lieferbar - On stock

○ A richiesta - Auf Anfrage - On request

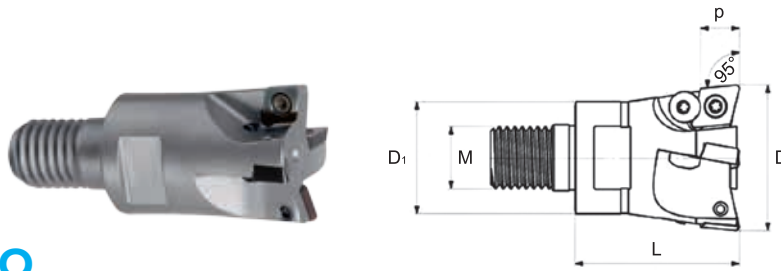

NEW ART. 410MO

CODICE ORDINE Bestell-Nr. Order No.	DIMENSIONI Abmessungen Dimensions (mm.)										STOCK
	D	D1	L	M	p	z					
410MO D16/2	16	12,7	23	M8	6	2	CDGX 0602...	VT25	BT08	0,030	○
410MO D20/3	20	17,7	30	M10	6	3				0,050	○
410MO D25/3	25	20,7	35	M12	6	3				0,090	○
410MO D25/4	25	20,7	35	M12	6	4				0,090	○

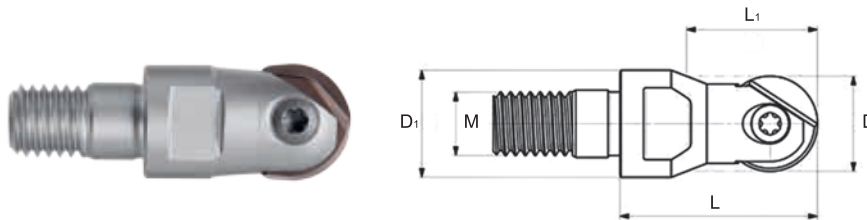
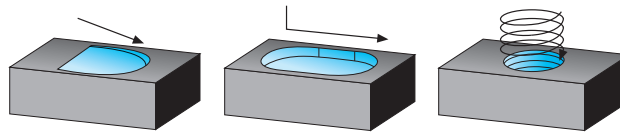

NEW ART. 420MO

CODICE ORDINE Bestell-Nr. Order No.	DIMENSIONI Abmessungen Dimensions (mm.)										STOCK
	D	D1	L	L1	M	z					
420MO D08/M6	8	9,7	23	16	6	2	BE08...	VTBE08	BT07	0,020	○
420MO D10/M6	10	9,7	23	23	6	2	BE10...	VTBE10	BT08	0,020	○
420MO D12/M6	12	9,7	23	23	6	2	BE12...	VTBE12	BT10	0,020	○
420MO D12/M8	12	13,5	25	19	8	2				0,030	○
420MO D16/M8	16	13,5	28	28	8	2	BE16...	VTBE16	BT15	0,030	○
420MO D20/M10	20	18,5	28	28	10	2	BE20...	VTBE20	BT20	0,050	○
420MO D25/M12	25	21	35	35	12	2	BE25...	VTBE25	BT25	0,080	○
420MO D32/M16	32	28,7	43	35	16	2	BE32...	VTBE32	BT40	0,160	○

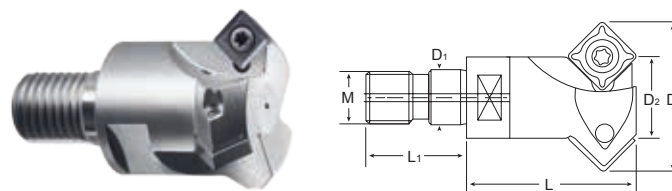
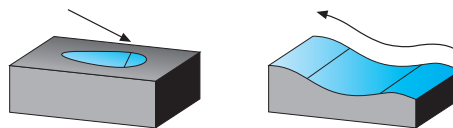

ART. 321 MO

CODICE ORDINE Bestell-Nr. Order No.	DIMENSIONI Abmessungen Dimensions (mm.)										STOCK	
	D	D1	D2	L	L1	M						z
321MO D12/1	23,7	8,5	12	30	17,5	8	1	SPGT SPMT 09T3...	VT35S	BT15	0,190	●
321MO D16/2	28,8	10,5	16	30	20	10	2				0,150	●
321MO D30/3	42,3	17	30	35	24	16	3				0,270	●

● Disponibile - Lieferbar - On stock

○ A richiesta - Auf Anfrage - On request

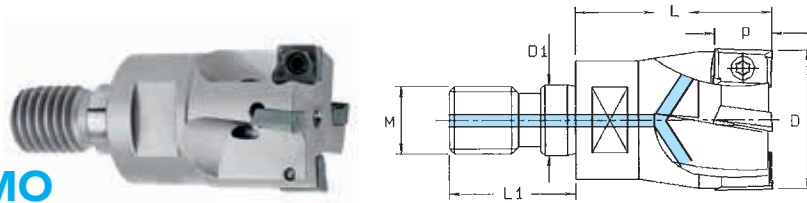

ART. 730MO

CODICE ORDINE Bestell-Nr. Order No.	DIMENSIONI Abmessungen Dimensions (mm.)								APHT APHX APKT 1604...	VT40	BT15	kg 0,220	STOCK ●
	D	D1	L	L1	M	p	β	z					
730MO D32/3	32	17	46	24	M16	17	2,0°	3				0,220	●
730MO D40/4	40	17	46	24	M16	17	1,5°	4				0,330	●

ART. 740MO

CODICE ORDINE Bestell-Nr. Order No.	DIMENSIONI Abmessungen Dimensions (mm.)								APHT APHX APKT 1003...	VT25	BT08	kg 0,010	STOCK ●
	D	D1	L	L1	M	p	β	z					
740MO D10/1	10	6,5	20	14,5	M6	10	11,0°	1				0,010	●
740MO D12/1	12	6,5	20	14,5	M6	10	9,0°	1				0,010	●
740MO D16/2	16	8,5	25	17,5	M8	10	3,5°	2				0,020	●
740MO D20/3	20	10,5	30	20	M10	10	1,5°	3				0,050	●
740MO D25/3	25	12,5	35	22	M12	10	0,9°	3				0,100	●
740MO D25/4	25	12,5	35	22	M12	10	0,9°	4				0,900	●
740MO D32/5	32	17	43	24	M16	10	0,6°	5				0,220	●

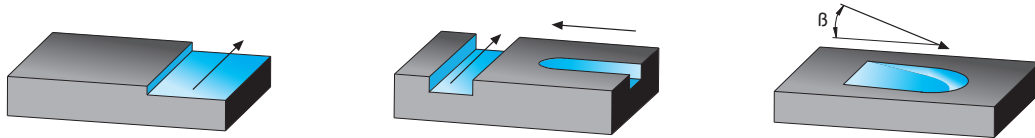

NEW ART. 741 MO

CODICE ORDINE Bestell-Nr. Order No.	DIMENSIONI Abmessungen Dimensions (mm.)								APKT 0602...	VT18 06	BT06	kg 0,010	STOCK ●
	D	D1	L	L1	M	p	z						
741MO D10/2	10	6,5	16	14,5	M6	5,2	2					0,010	●
741MO D12/3	12	6,5	16	14,5	M6	5,2	3					0,010	●
741MO D16/4	16	8,5	21	17,5	M8	5,2	4					0,020	●
741MO D20/5	20	10,5	26	20	M10	5,2	5					0,050	●
741MO D25/7	25	12,5	30	22	M12	5,2	7					0,100	●

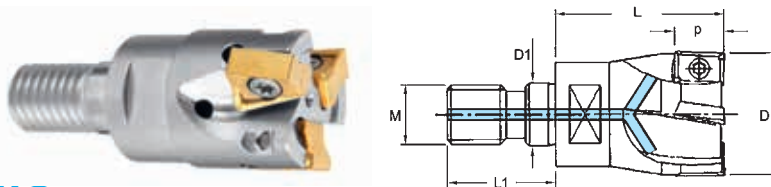

ART. 745

CODICE ORDINE Bestell-Nr. Order No.	DIMENSIONI Abmessungen Dimensions (mm.)								LNEX LNKX LNMX 10...	VT 30 745	BT09	kg 0,050	STOCK ●
	D	D1	L	L1	M	p	β	z					
745MO D20/3	20	10,5	30	20	M10	10	4,0°	3				0,050	●
745MO D25/3	25	12,5	35	22	M12	10	3,5°	3				0,100	●
745MO D32/4	32	17	43	24	M16	10	3,0°	4				0,230	●

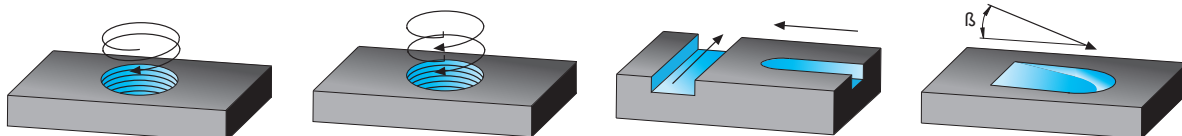

● Disponibile - Lieferbar - On stock

○ A richiesta - Auf Anfrage - On request

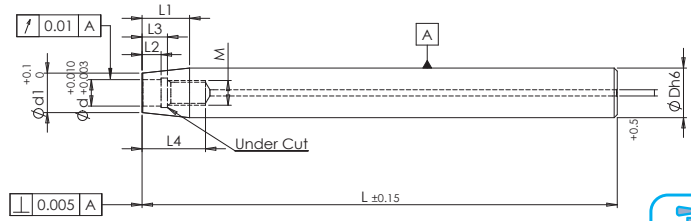

ART. PCIMD

CODICE ORDINE Bestell-Nr. Order No.	D	d	d1	L	L1	L2	L3	L4	M	kg	STOCK
PCIMD12 060 M06	12	6,5	9,7	60	15	5	8	19	6	0,100	○
PCIMD12 080 M06	12	6,5	9,7	80	15	5	8	19	6	0,140	○
PCIMD12 100 M06	12	6,5	9,7	100	15	5	8	19	6	0,200	○
PCIMD12 150 M06	12	6,5	9,7	150	15	5	8	19	6	0,300	○
PCIMD16 080 M08	16	8,5	12,7	80	15	6	9	20	8	0,350	○
PCIMD16 100 M08	16	8,5	12,7	100	15	6	9	20	8	0,350	○
PCIMD16 120 M08	16	8,5	12,7	120	15	6	9	20	8	0,350	○
PCIMD16 150 M08	16	8,5	12,7	150	15	6	9	20	8	0,350	○
PCIMD16 200 M08	16	8,5	12,7	200	15	6	9	20	8	0,600	○
PCIMD20 100 M10	20	10,5	17,7	100	20	10	13	26	10	0,500	○
PCIMD20 140 M10	20	10,5	17,7	140	20	10	13	26	10	0,700	○
PCIMD20 200 M10	20	10,5	17,7	200	20	10	13	26	10	0,900	○
PCIMD25 100 M12	25	12,5	20,7	100	30	10	13	26	12	0,500	○
PCIMD25 150 M12	25	12,5	20,7	150	30	10	13	26	12	0,500	○
PCIMD25 200 M12	25	12,5	20,7	200	30	10	13	26	12	0,900	○
PCIMD25 250 M12	25	12,5	20,7	250	30	10	13	26	12	1,000	○
PCIMD32 100 M16	32	17	28,7	100	30	10	14	30	16	1,250	○
PCIMD32 150 M16	32	17	28,7	150	30	10	14	30	16	1,900	○

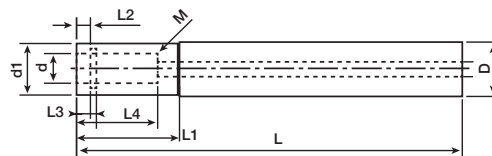

NEW ART. PCCMD

CODICE ORDINE Bestell-Nr. Order No.	D	d	d1	L	L1	L2	L3	L4	M	kg	STOCK
PCCMD10 150 M6	10	6,5	9,8	150	30	5	7	19	6	0,300	○
PCCMD12 150 M6	12	6,5	10,8	150	27	5	7	19	6	0,300	○
PCCMD16 150 M8	16	8,5	15	150	27	6	8	20	8	0,350	○
PCCMD16 200 M8	16	8,5	15	200	31	6	8	20	8	0,600	○
PCCMD20 200 M10	20	10,5	18	200	36	10	12	24	10	0,900	○
PCCMD20 250 M10	20	10,5	18	250	44	10	12	24	10	1,000	○
PCCMD25 200 M12	25	12,5	22,5	200	36	10	12	26	12	0,500	○
PCCMD25 250 M12	25	12,5	22,5	250	44	10	12	26	12	1,000	○
PCCMD32 250 M16	32	17	28,6	250	44	10	13	28	16	2,100	○
PCCMD32 300 M16	32	17	28,6	300	52	10	13	28	16	2,300	○

● Disponibile - Lieferbar - On stock

○ A richiesta - Auf Anfrage - On request